

THE ENTIRE PREMISES MAY BE USED FOR THE SALE OF ALCOHOL AND THE PROVISION OF LATE NIGHT REFRESHMENT

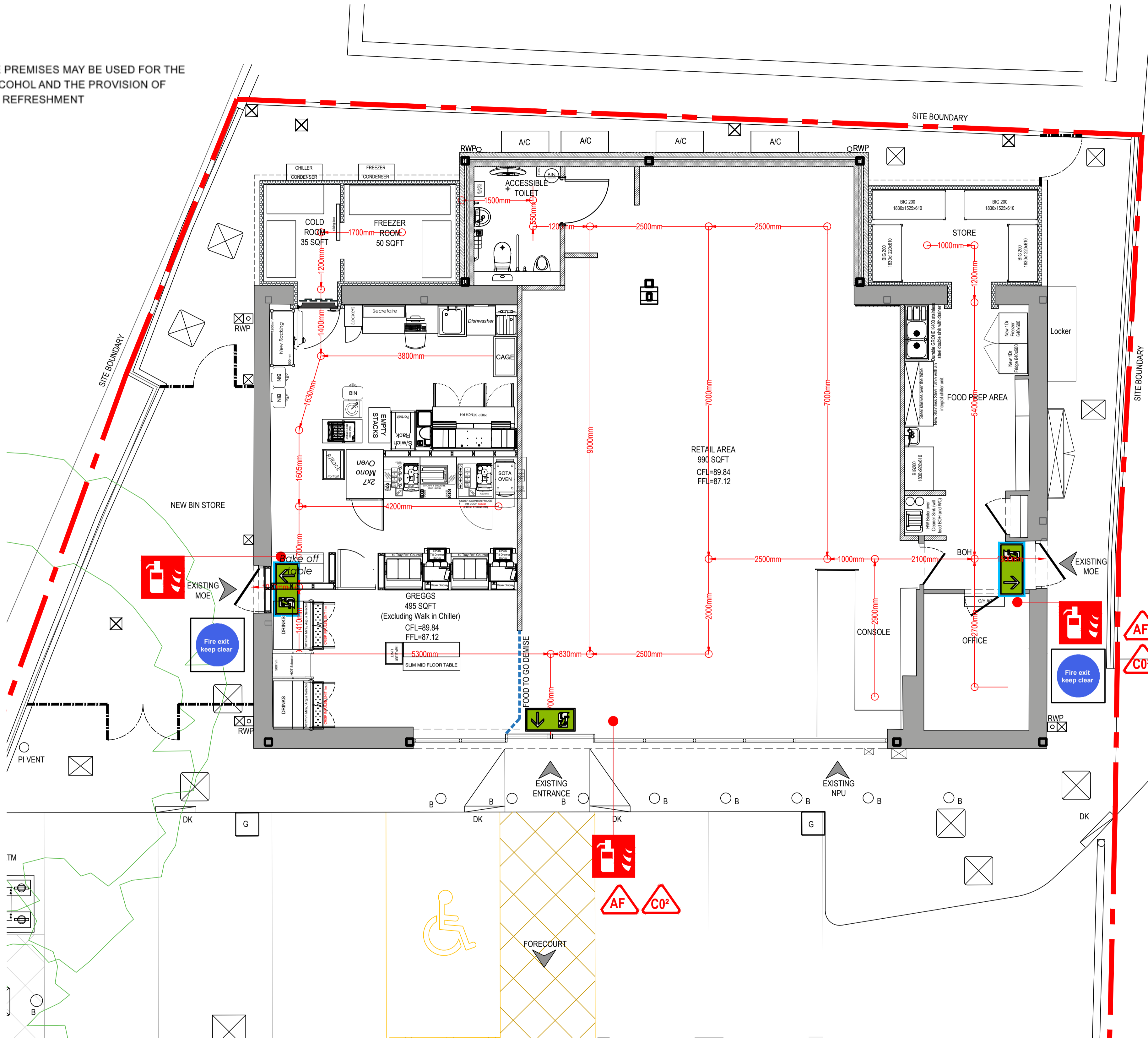

DRAWING NOTES
 COPYRIGHT ©
 This drawing and the details herein are the copyright of MBH Design Studio Ltd. and must not be reproduced, altered or passed to any third party without prior written consent.
 This drawing has been produced for the project listed below, is submitted in support of this application to the Local Planning Authority and is not intended for use by any other person or for any other purpose.
 Every effort has been made to ensure the accuracy of these drawings, however MBH Design Studio Ltd. accept no responsibility for any discrepancies arising from the reuse of survey information and preliminary drawings commissioned by the Applicant from others.

GENERAL NOTES
ESCAPE LIGHTING
 AS DEFINED BY BRITISH STANDARD 5266:PART 1 (2016) SHALL BE PROVIDED TO THESE PREMISES, SUFFICIENT TO ENABLE PERSONS TO EXIT BUILDING IN THE EVENT OF FAILURE OF NORMAL LIGHTING
FIRE FIGHTING EQUIPMENT
 SHOULD BE PROVIDED AS DETAILED AND IN ACCORDANCE WITH BRITISH STANDARD 5306:PART 3 (2017)
FIRE FIGHTING SYSTEM
 TO BE PROVIDED WITH FIRE WARNING SYSTEM COMPLYING WITH BRITISH STANDARD 5839:PART 1 (2017)
FIRE ALARM SYSTEM
 TO BE INSTALLED IN ACCORDANCE WITH BS 5839:PART 1 (2017)
NOTICES:
 A 'RUNNING MAN' SIGN SHALL BE INSTALLED ABOVE DOORS IN ACCORDANCE WITH BS5499
NOTICES:
 FIRE SAFETY SIGNS SHALL BE INSTALLED ABOVE DOORS IN ACCORDANCE WITH BS5499:PART 1

--- 30 MIN FIRE RATED FIRE CONSTRUCTION TO FIRE COMPARTMENTS (NOT GREATER THAN 20M) INCLUDING CONCEALED FIRE BARRIERS.
 --- 60 MIN FIRE RATED CONSTRUCTION INCLUDING CONCEALED FIRE BARRIERS.

FIRE EXIT SIGNAGE DETAILS

| | | |
|-----------------------|--|---|
| A) WALL MOUNTED SIGN: | | ADHESIVE BACKED OR DRILLED FOR FIXING. 50MM ABOVE DOORS/OPENINGS |
| B) SUSPENDED SIGN: | | EACH COMPLETE WITH 2NO S/S STEEL WIRES AND NECESSARY FIXINGS. HEIGHT AFFL TO MATCH OTHER INTERNAL SIGNAGE |

ALL FIRE SIGNS MUST CONFORM TO BS5499-1:2002, BS5499-4:2016, BS5499-5, 6:2002, BS5499-11:2002 & BS180 7010 2020

EMERGENCY FIRE EXIT DIRECTION SIGNS OVER ESCAPE ROUTE DOORS MUST BE ILLUMINATED

LOCATION OF SMOKE DETECTOR WITH CEILING VOID DETECTION AND LED WARNING AT CEILING LEVEL.
 LOCATION OF SMOKE DETECTOR
 HEAT DETECTOR
 NOTE= Location of smoke and heat detector to be confirmed by specialist and to be installed in accordance with manufactures requirements.
 FIRE STRATEGY ROUTE
 "FIRE EXIT - KEEP CLEAR" VINYL SIGN APPLIED TO DOOR EXTERIOR
 NOTE: Main contractor to inspect fire escape signage for compliance with current regulation.

FIRE FIGHTING EQUIPMENT

FIRE FIGHTING EQUIPMENT LOCATION

AQUEOUS FILM FORMING FOAM 6 LITRE 27A-AFFF
 CO² 2KG

FIRE EXTINGUISHER PATTERSSING - 25 x 150 x 600 mm LONG SOFTWOOD CHAMFERED PATTERSSING FIXED AT 1m TO TOP OF PATTERSSING FROM FFL

NOTICES:
 PROVIDE EXIT BUTTONS AND BREAK GLASS POINTS AT 1200MM AFFL TO ALL AREAS WITH ACCESS CONTROL.
 PROVIDE FIRE BARRIER TO CEILING / FLOOR VOIDS AT 20M CENTRES MAXIMUM.
 ALL SERVICE PENETRATIONS IN COMPARTMENT WALLS, FLOOR & SOFFIT TO BE FIRE-STOPPED WITH THE APPROPRIATE FIRE DAMPERS.
 PROVIDE STATUTORY FIRE/WARNING SIGNS TO MOE DOORS AS REQUIRED.
 PROVIDE FIRE DETECTION AND ALARM SYSTEM TO BS 5839 PART 1 AND TO L1 STANDARD.
 PROVIDE ESCAPE LIGHTING TO BS 5266 PART 1.
 SPREAD OF FLAME TO WALL AND CEILING SURFACES IN THE SALES BUILDING SHOULD BE NOT LESS THAN CLASS 1 AND ESCAPE CORRIDORS NOT LESS THAN CLASS 0.

| | | | |
|----------------|------------|--------------------|---------------|
| A | 2023-09-06 | Construction Issue | LBES |
| REV | DATE | DESCRIPTION | DRAWN/CHECKED |
| REVISION NOTES | | | |

CONSTRUCTION

MBH Design Studio Ltd.
 Rosemount House, Rosemount Avenue, West Byfleet, Surrey, KT14 6LB
 www.mbhstudio.com t: 01932 350 727 f: 01932 351 545

CLIENT

PROJECT
 FS914 LEITH HILL SERVICE STATION
 A24, HORSHAM ROAD
 BEARE GREEN, DORKING
 SURREY, RH5 4QU

DRAWING TITLE
 PROPOSED FIRE STRATEGY PLAN

| | | | |
|------------|----------------|-------|------------|
| DRAWN BY | DATE | SCALE | PAPER SIZE |
| LB | 19.05.2023 | 1:50 | A1 |
| CHECKED BY | DRAWING NUMBER | REV | |
| JR | 13998-311 | A | |

